

**A LAY-IN FIXTURE MOUNTING**  
SCALE: N.T.S.

Panel: LA		Load Type:		Voltage:	A.I.C. Rating:
L= Lighting, R=Receptacle, M=Motors, HO= Hotel K=Kitchen, H=HVAC, MI= Misc		208/120		10000A	
Phase: Three		Wires: 4W + G		Mains Rating: 225A	
Enclosure: Type 1		Sections: One		Main Breaker Size: 200A	
				Panel Lugs: Main Circuit Breaker	
				Mounting: Surface	

Circ No.	Load Description	Trip	Poles	Load	A	B	C	Load	Poles	Trip	Load Description	Circ No.	
1	RECPTS - RM 101,102,103	20	1	R	720	3960		H	3	45	RTU-1	2	
3	RCPT - RTU	20	1	R		180	3960	H				4	
5	RECPTS - RM 101	20	1	R			720	3960	H			6	
7	L.T. RACK	20	1	R	1000	1000		H	2	15	EH-1	8	
9	DRINKING FOUNTAIN	20	1	R		500	1000	H				10	
11	DRINKING FOUNTAIN	20	1	L			500	1000	H	2	15	EH-2	12
13	LIGHTS	20	1	L	1590	1000		H				14	
15*	EXTERIOR LIGHTING	20	1	L		100	4150	MI	2	50	WH-1	16	
17	UPS-1	20	1	R				4150	MI			18	
19	UPS-2	20	1	R		936		M	3	15	GP-1	**20	
21	ROOF HOOD	20	1	M			936	M				22	
23	DAMPER ACTUATOR	20	1	MI				936	M			24	
25	SPARE	20	1	MI					MI	1	20	SPACE ONLY	26
27	SPARE	20	1	MI					MI	1	20	SPACE ONLY	28
29	SPARE	20	1	MI					MI	1	20	SPACE ONLY	30
31	SPARE	20	1	MI					MI	1	20	SPACE ONLY	32
33	SPACE ONLY	20	1	MI					MI	1	20	SPACE ONLY	34
35	SPACE ONLY	20	1	MI					MI	1	20	SPACE ONLY	36
37	SPACE ONLY	20	1	MI					MI	1	20	SPACE ONLY	38
39	SPACE ONLY	20	1	MI					MI	1	20	SPACE ONLY	40
41	SPACE ONLY	20	1	MI					MI	1	20	SPACE ONLY	42
a - Arc Fault Breaker				Total (KVA)	10.206	10.826	11.266						
b - Shunt Trip Breaker				Total Connected (KVA):	32.30								
c - GFCI Breaker				Total Connected (Amps):	89.65								

Notes: \*VIA CONTACTOR  
\*\*GRIND PUMP SHALL BE PRICED AS PART OF ALTERNATE #4.

Per NEC, Article 220 for Lighting and General Receptacle Loads

Load Classification	Connected Load (KVA)	Demand Factor	Demand (KVA)	Panel Totals
Lights	2.2	1.25 Continuous	2.7	Total Demand (KVA): 32.8
Receptacles	3.1	Per NEC 220	3.1	
Motors	2.8	Per NEC 220	2.8	Demand Amps: 91.2
Hotel	0.0	Per NEC 220	0.0	
Kitchen	0.0	Per NEC 220	0.0	
HVAC	15.9	Per NEC 220	15.9	
Misc	8.3	1.00	8.3	

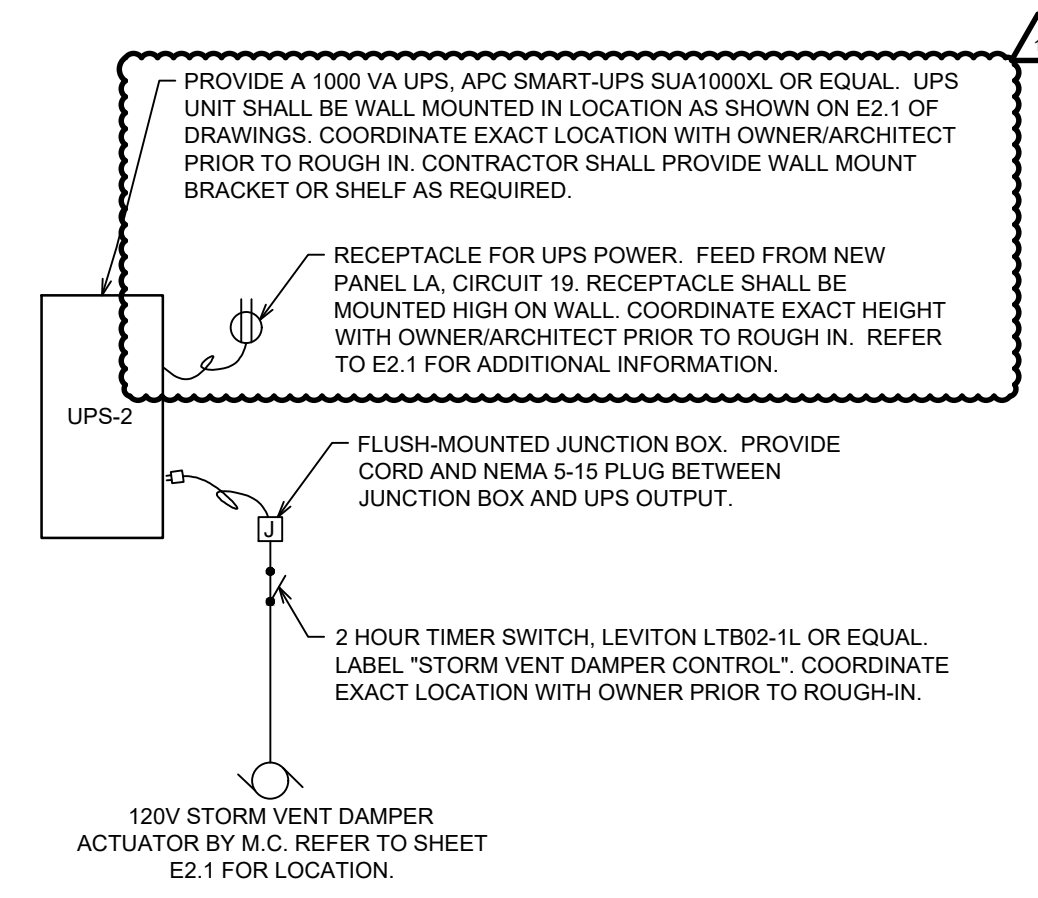

**B STORM VENT CONTROL DETAIL**  
SCALE: N.T.S.

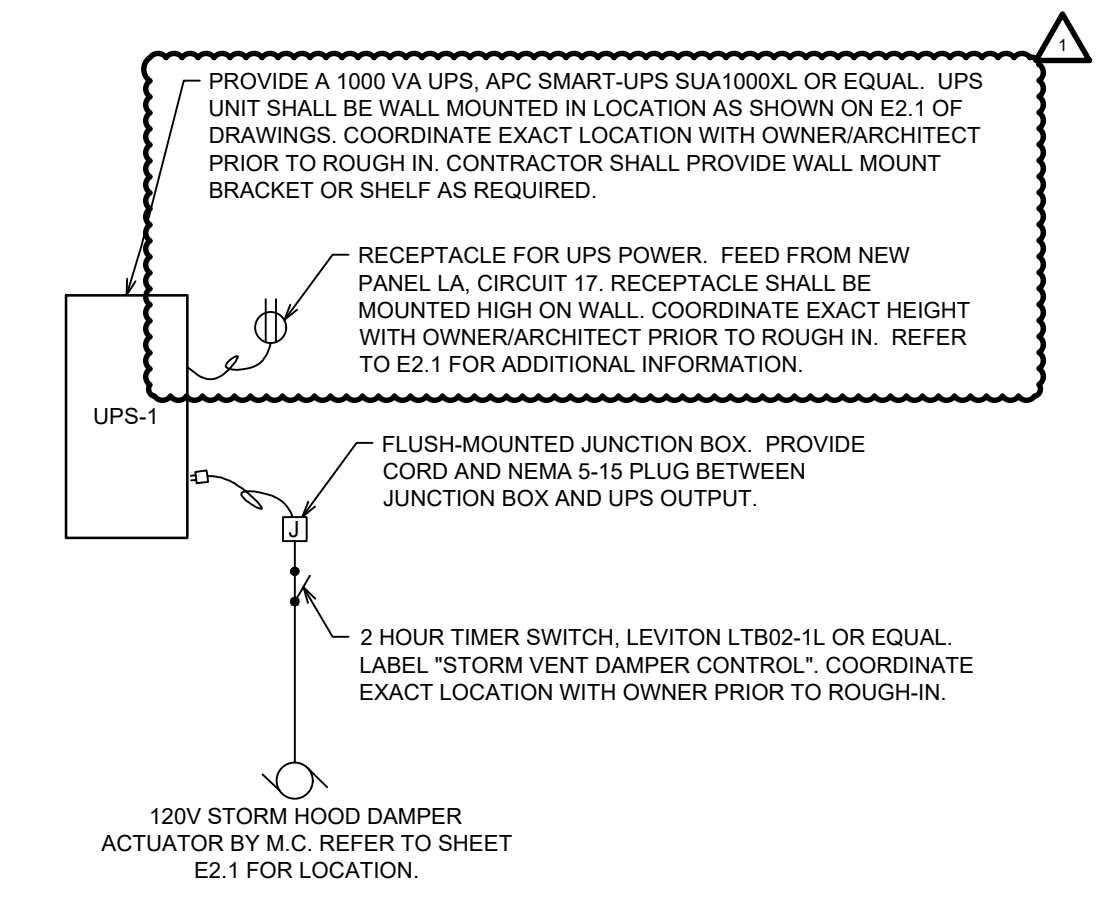

**C STORM HOOD CONTROL DETAIL**  
SCALE: N.T.S.

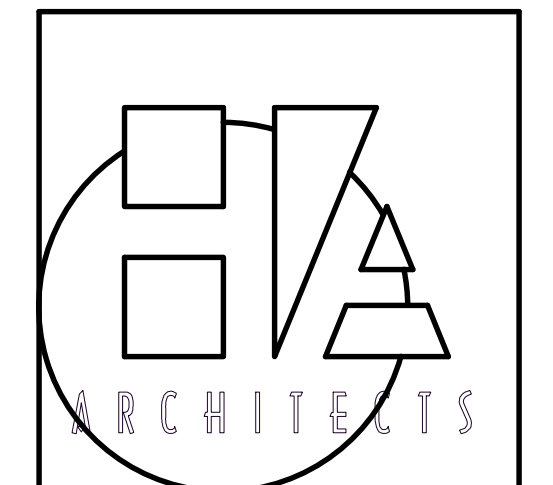

HANNEY & ASSOCIATES, ARCHITECTS  
1726 South Hillside, Wichita, Kansas, 67211  
Phone (316) 683-8965  
Fax (316) 684-1441  
www.haarchitects.com

**2021 UDALL HIGH SCHOOL FEMA SHELTER ADDITION UNIFIED SCHOOL DISTRICT #463**

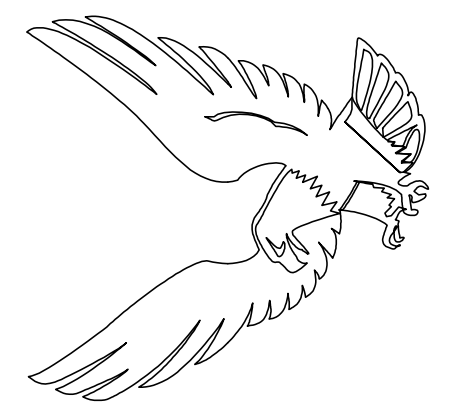

DRAWINGS ISSUED		
NO.	DATE	ITEM ISSUED
4	2/26	ADDENDUM 2
8	2/18	ADDENDUM 1
7	2/3	ISSUED FOR BIDS
6	1/11	BOE REVIEW
5	11/24	BOE REVIEW
4	11/4	BOE REVIEW
3	10/26	REVIEW
2	10/16	REVIEW
1	10/08	REVIEW

COMPUTER DRAWING

DATE: JANUARY 2021  
DRAWN BY: CHECKED BY:

SHEET  
**E1.2**  
OF 1 SHEETS



20260.00 - 107